

FOR LEASE

4063 Viscount Avenue
Memphis, TN 38118
Southeast Submarket



361,000+/- SF Warehouse Available

Property Highlights

- New TPO roof installed 8/2016
- New T5 energy efficient, high output light fixtures on motion sensors throughout
- Includes 10,022 SF office
- Superior interstate access
- Rail served
- Perimeter fencing
- Zoned I-H (Heavy Industrial)
- Built in 1979
- Concrete tilt-up construction
- 63% of warehouse area has 32' ceiling height (ranges to 20')
- 26 dock high doors, 17 with levelers
- 2 ramp access docks
- 13 rail docks
- 1 grade level dock door
- 33' x 25' average column spacing
- Ample trailer storage capacity
- Class 4 rated sprinkler system
- Additional 40k sf mezzanine space available

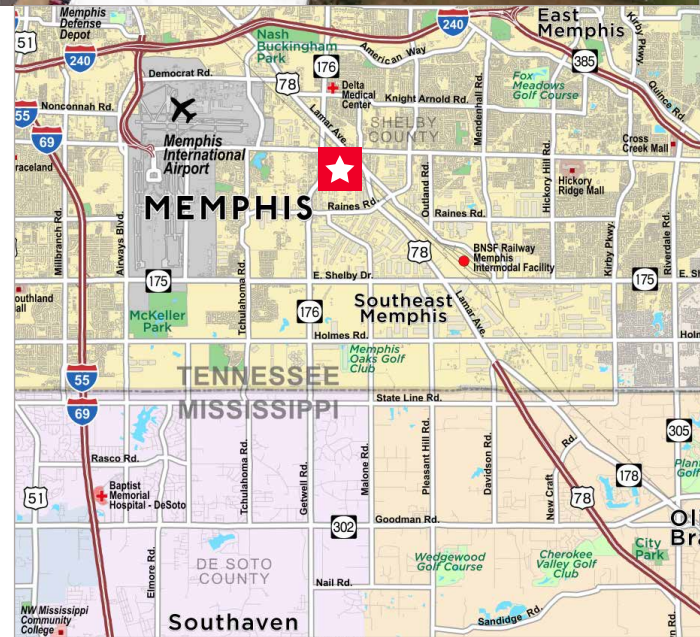

Dave Curran, SIOR, CCIM
 Senior Vice President
 901 273 2358
 dcurran@commadv.com

5101 Wheelis Drive, Suite 300
 Memphis, TN 38117
 Main: 901 366 6070
www.commadv.com

Independently Owned and Operated / A Member of the Cushman & Wakefield Alliance

Cushman & Wakefield Copyright 2015. No warranty or representation, express or implied, is made to the accuracy or completeness of the information contained herein, and same is submitted subject to errors, omissions, change of price, rental or other conditions, withdrawal without notice, and to any special listing conditions imposed by the property owner(s). As applicable, we make no representation as to the condition of the property (or properties) in question.



FOR LEASE

4063 Viscount Avenue

Memphis, TN 38118

Southeast Submarket

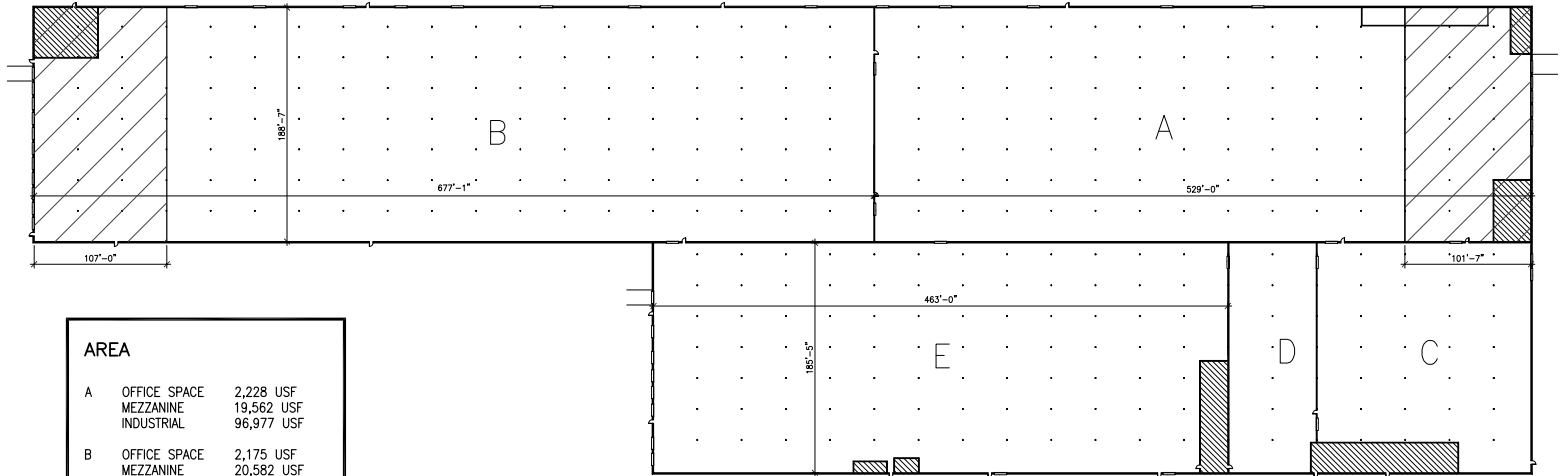

AREA		
A	OFFICE SPACE	2,228 USF
	MEZZANINE	19,562 USF
	INDUSTRIAL	96,977 USF
B	OFFICE SPACE	2,175 USF
	MEZZANINE	20,582 USF
	INDUSTRIAL	127,019 USF
C	OFFICE SPACE	3,007 USF
	INDUSTRIAL	29,572 USF
D	INDUSTRIAL	13,212 USF
E	OFFICE SPACE	2,612 USF
	INDUSTRIAL	84,202 USF

 **1 FLOOR PLAN**
NOT TO SCALE

5101 Wheelis Drive, Suite 300
 Memphis, TN 38117
 Main: 901 366 6070
www.commadv.com